

### Step 1. Interior Carcass Assembly

Using screws # 1 , combine the interior (acoustic foam application) top, bottom and side panels into a single carcass.

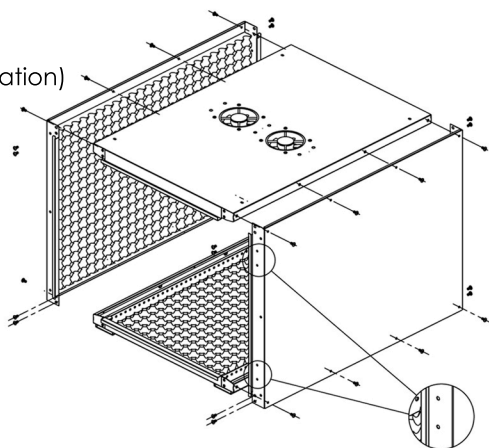

### Step 2. Vertical Rails Installation.

Using screws M6 (#1) and nuts (#2), install the vertical mounting rails at the distance suitable for your equipment.

Leave some clearance between the doors for air flow circulation and wiring.

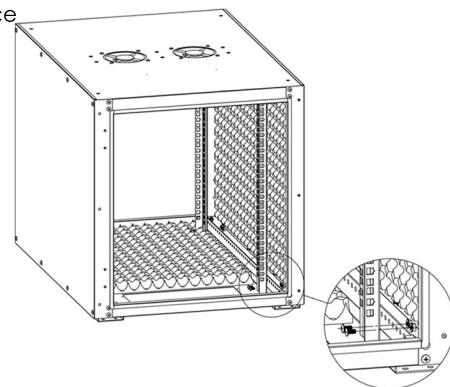

### Step 3. Casters Installation

Screw casters to the boot using screws # 1.

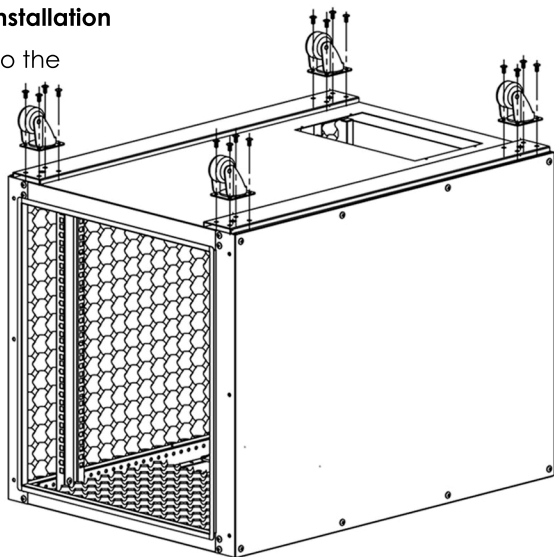

### Step 4. Exterior Top Installation.

Using screws# 1, install the top.

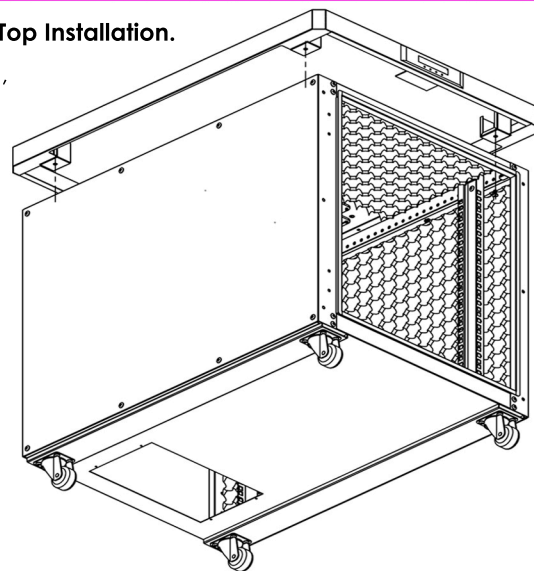

### Step 5. Exterior Side Panels Installation.

Using screws# 3, install the exterior Side Panels.

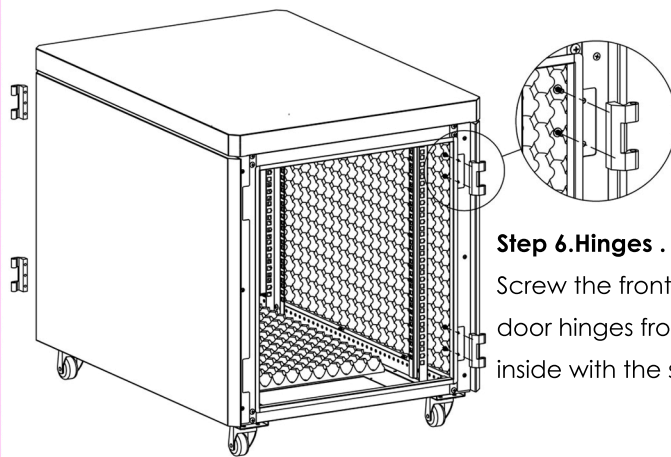
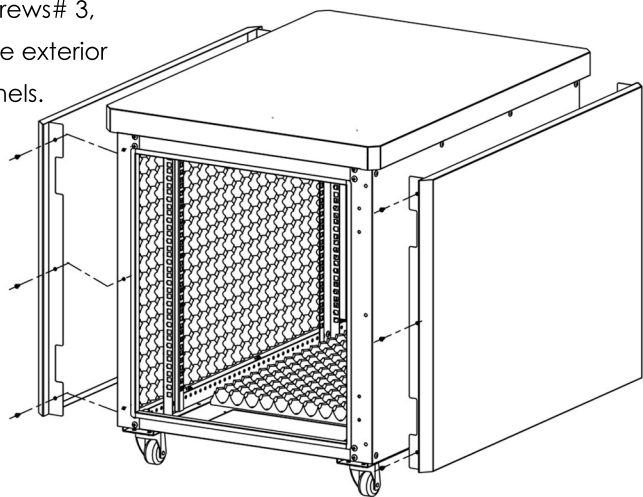

### Step 6. Hinges .

Screw the front/rear door hinges from the inside with the screws# 4

### Step 7. Doors Installation.

Pull the metal pins out of the hinges and install the doors. Secure the pins back into the hinges.

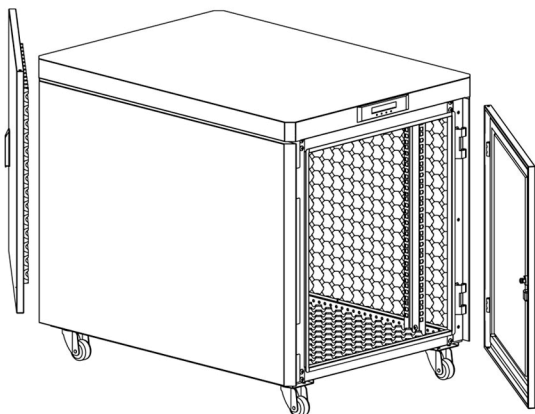

Step 8. Using screws# 5, install the foam cable entry.

