

List of hardware box for SRF900			STEP
Name	Qty	PVC bag number	
M6*15 bolts	35pcs	<b>1 (35PCS)</b>	5 and 8
M6 nuts	26pcs	<b>2 (26PCS)</b>	5 and 8
M8*12 bolts	16pcs	<b>3 (16PCS)</b>	3
M6 mounting hardware	50sets	<b>4 (50SET)</b>	
M5 self tapping screws	25pcs	<b>5 (25PCS)</b>	2 and 12
M4 self tapping screws	22pcs	<b>6 (22PCS)</b>	6
M5*10 bolts	50pcs	<b>8 ( 50PCS)</b>	1 and 7
Rubber damper and steel damper 8pcs and door bushing 2pcs	8pcs	<b>7 (8PCS)</b>	10
Latch locks for the front/rear door	2pcs	/	11
small round lock for side panels	2pcs	/	9
Castors	4pcs	/	2
Legs	4pcs	/	2
Silver stoppers (corners)	4pcs	/	6

# Main Structure

Server Rack Sysracks SRF 18-42.6.9 Glass Front Door

Color: Black 9005 or Gray 7035

Max Loading Capacity: 1600 Lbs

External Dimensions: 24"X35"X76" (600mm X 900mm X 2133mm) with casters

Mounting Holes Type: Square

Max Adjustable Distance between Vertical Mounting Rails: 31"

Internal Height: 42U

Compatibility: 19" Standard AV Telecommunication and Server Equipment

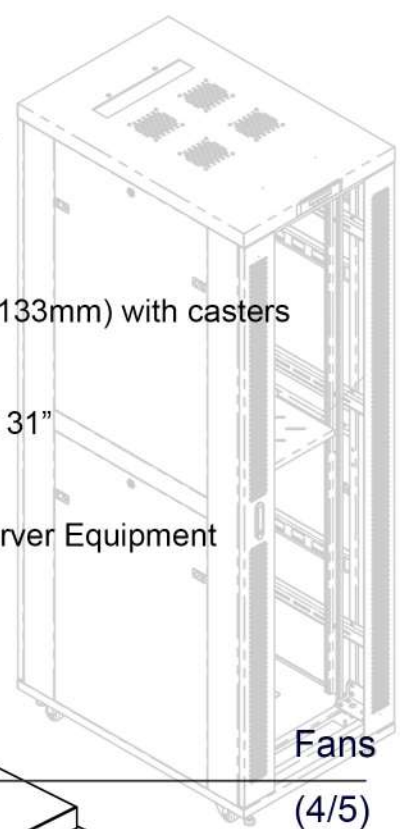

TOP (4/5)

Brush cable  
entry (4/5)

Rear  
door (2/5)

Horizontal  
beam (4/5)

Side  
panel (3/5)

Supporting  
beam (5/5)

Reinforcing  
angle (5/5)

Bottom (4/5)

Caster (4/5)

Fans  
(4/5)

Horizontal  
frame (5/5)

U-mark  
rail (1/5)

Front  
door (2/5)

Horizontal  
beam (4/5)  
Vertical  
frame (1/5)

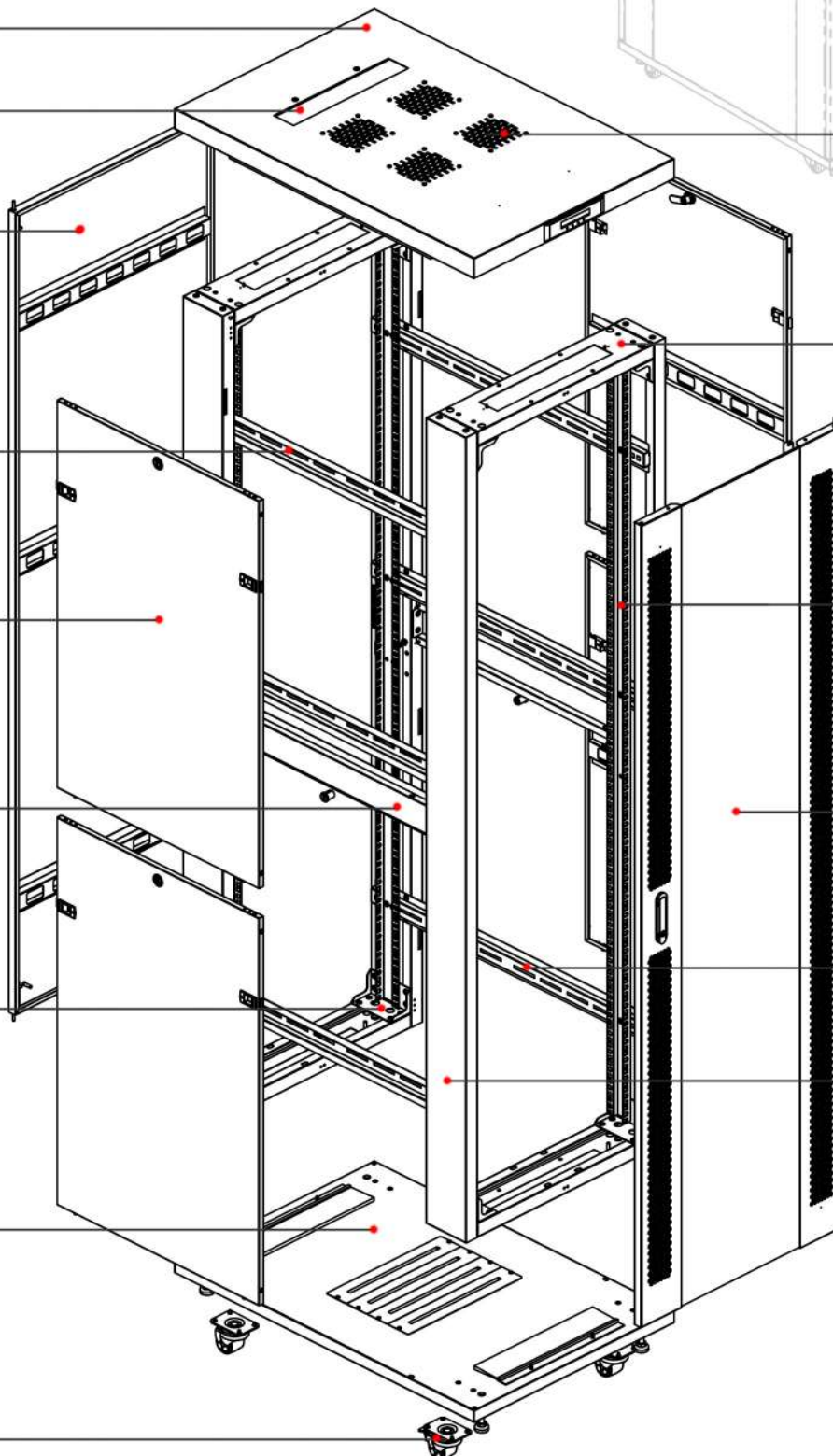



### Before Assembly

- Tools Required on Assembly:  
Crosshead Screwdriver (Preferably Electrical Screwdriver),  
Utility Knife.
- 2 people are required on unpacking/assembly/relocation  
the Server Rack/Parts.
- Ensure having enough space and flat levelled surface before  
assembly and installation to minimize the risk of tipping over.
- House the heaviest equipment towards the bottom and light  
equipment towards the top a serve rack
- All bolts connection must be tightened at the end of assembly  
process to straighten the construction.

## The Server Rack SRF Series is supplied in 5 flat packages:

### (1/5) - Vertical Frames Package

Vertical Frames-4 pcs

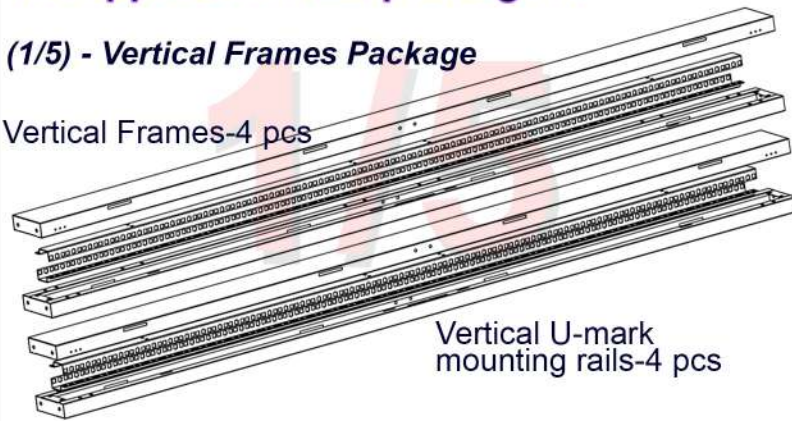

Vertical U-mark  
mounting rails-4 pcs

### (2/5) - Doors package (Front/Rear)

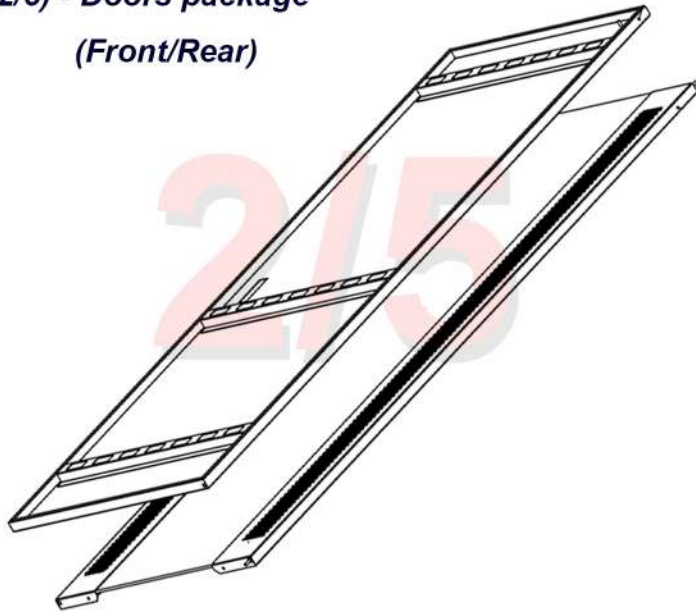

### (3/5) – Side Panels Package

18U/22U/27U – 2 pcs,  
32U/42U – 4 pcs

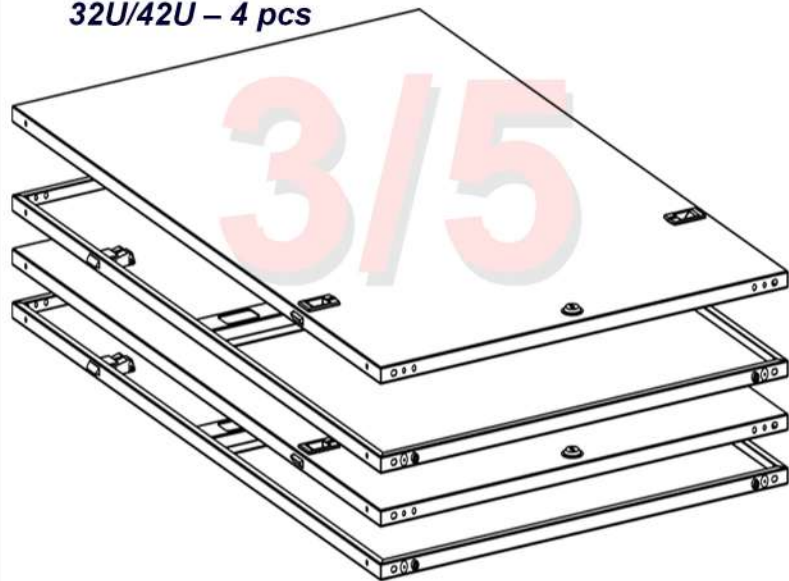

### (4/5) – Top/Bottom, Hardware Package

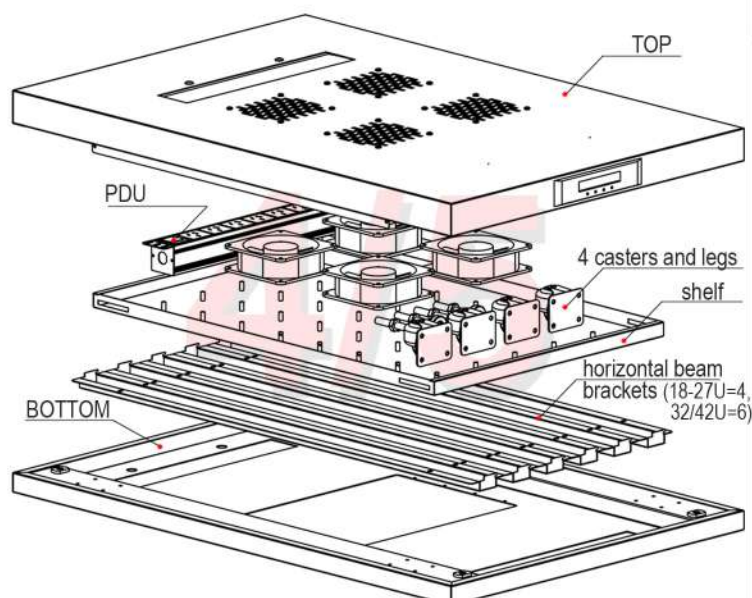

### (5/5) – Horizontal Frames

### and Reinforcing Angles Package

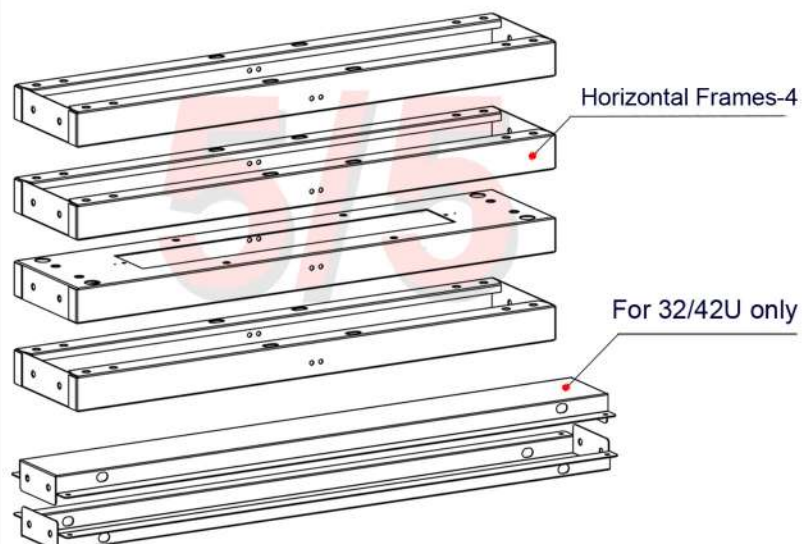

Horizontal Frames-4

For 32/42U only

# **STEP# 1**

***Building the Main Frames:***

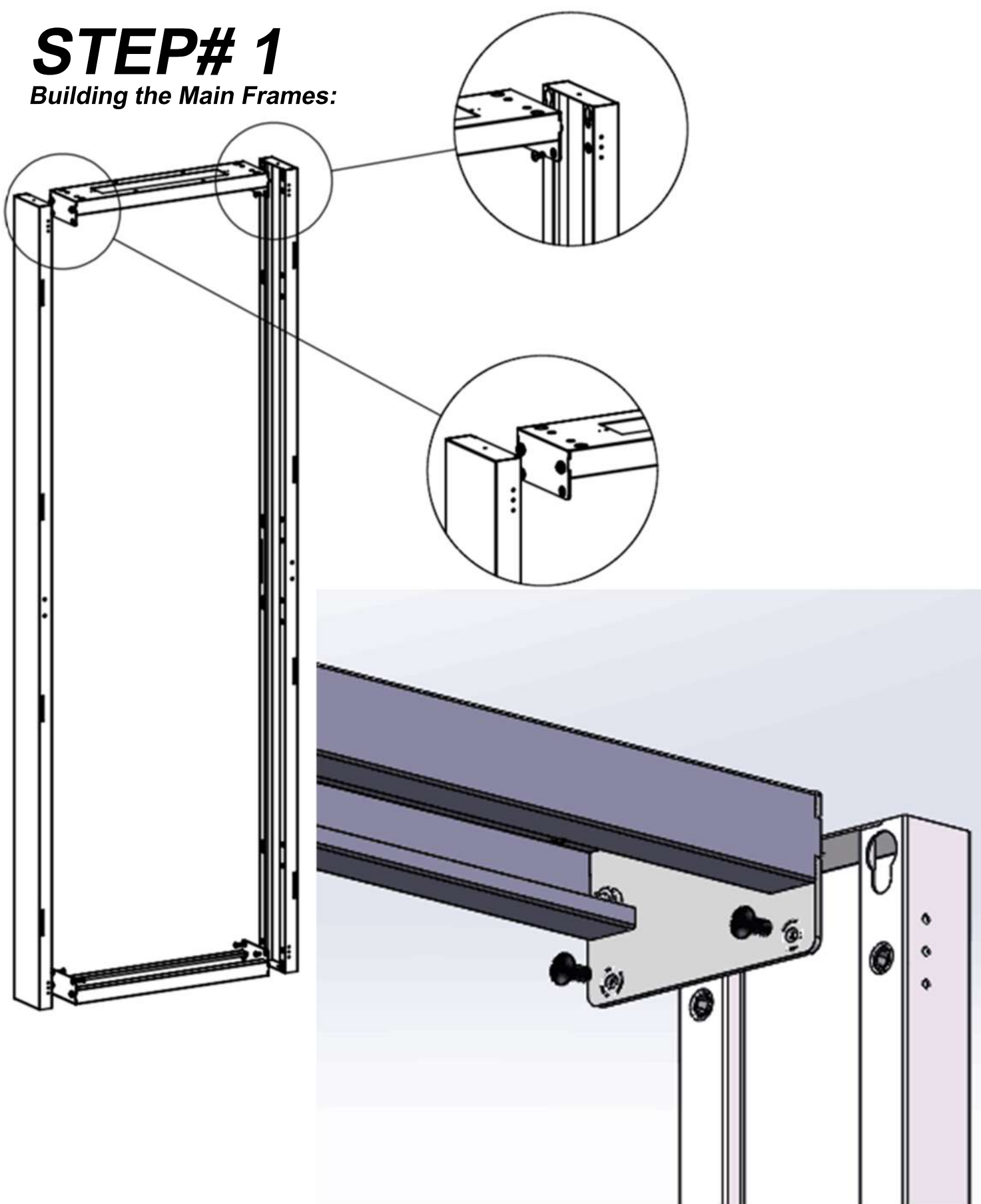

***Combine the Horizontal (package 5/5) and Vertical (package 1/5) frame parts into one single carcass.***

***Secure each connection with 2 X M5 bolts (plastic bag #8).***

***The hardware kit enclosed in package 4/5***



## **STEP #2**

***Using the screws # 5,  
install the casters.  
Install the adjustable  
legs.***

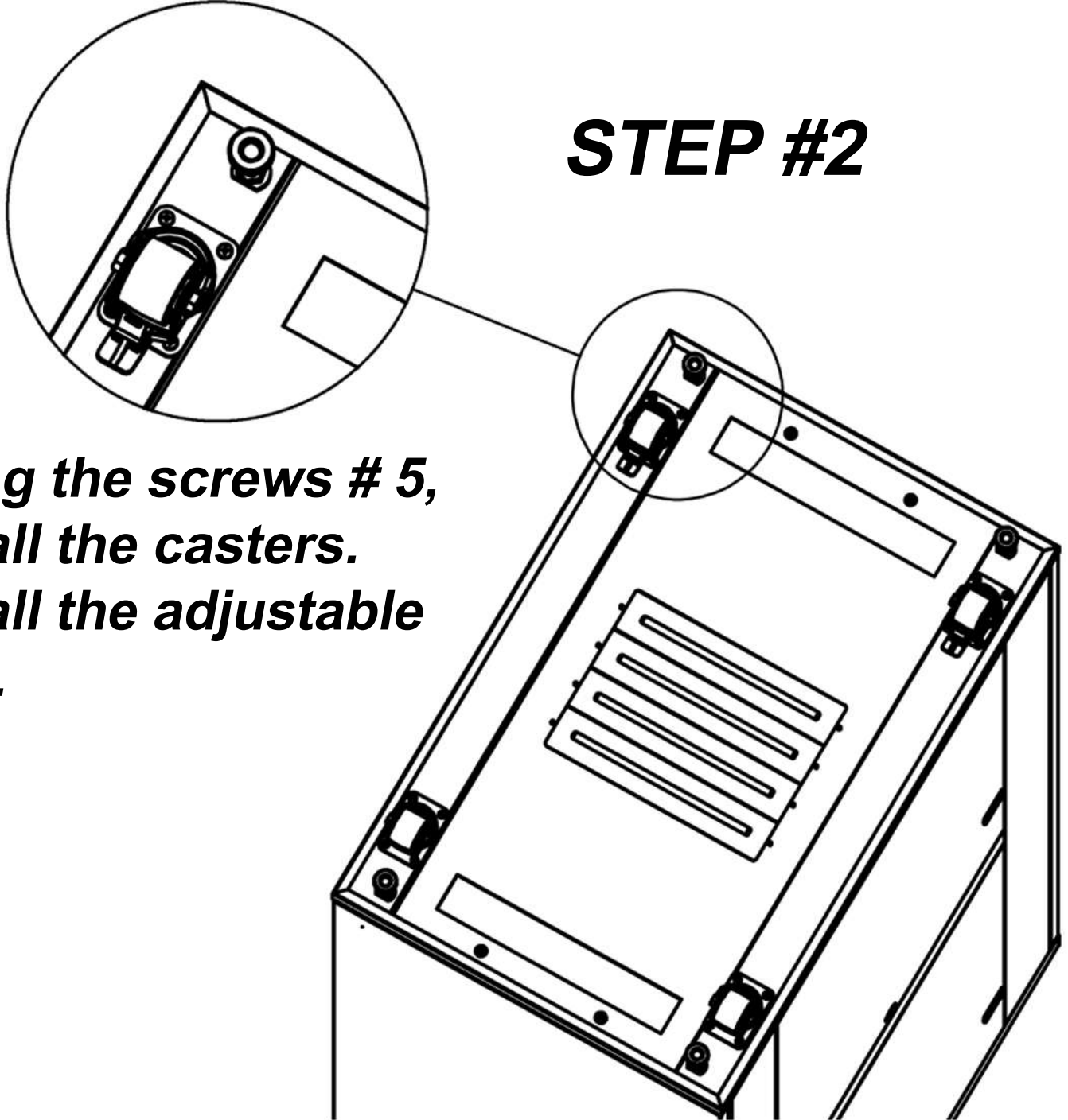

### ***STEP #3***

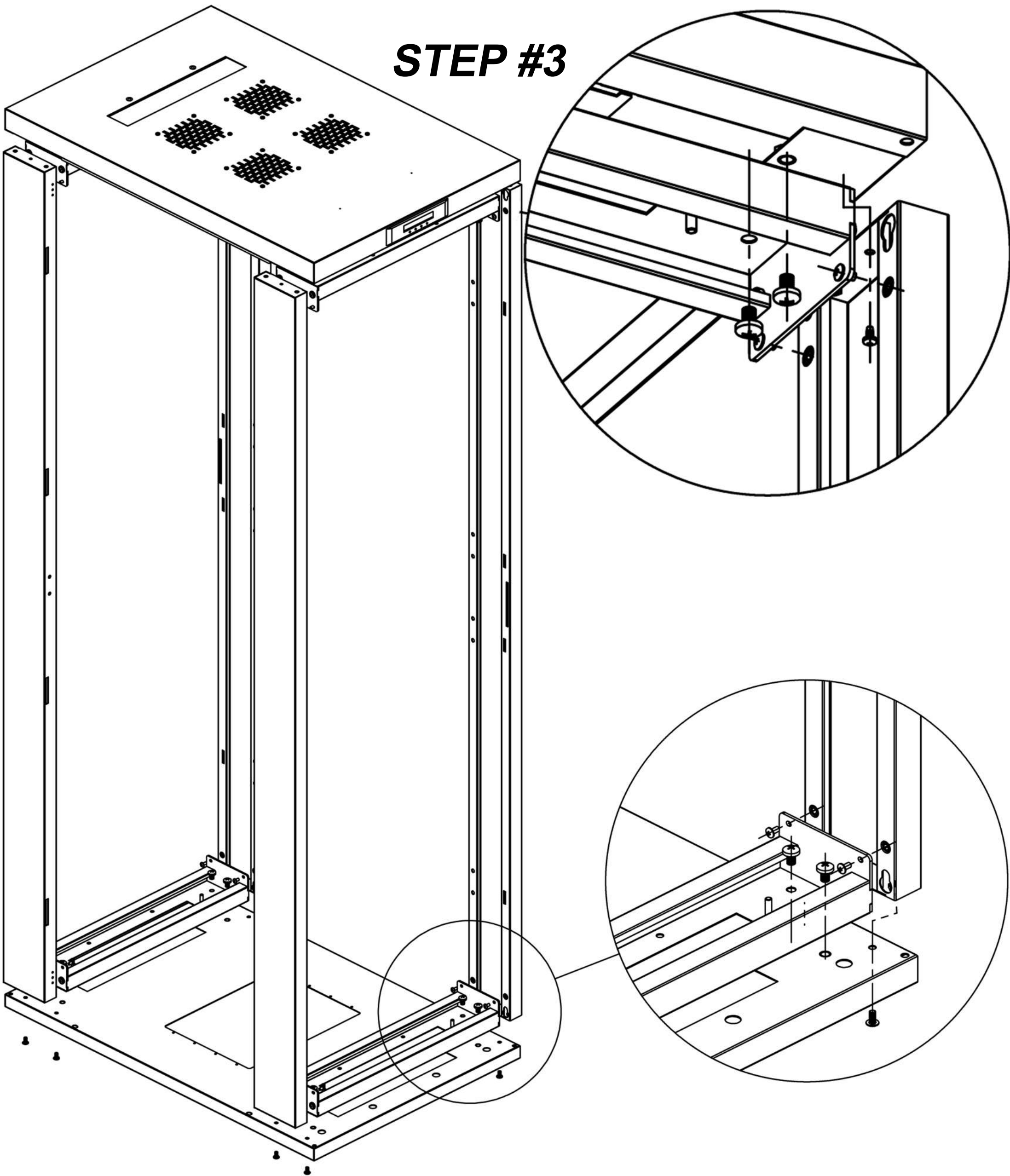

***Using the bolts # 3 (M8),  
bolt 2 main frames  
with Bottom and bottom parts  
from the inside the rack.***

***! The vertical frame round holes should face inside and the rectangular/square holes outside the rack.***

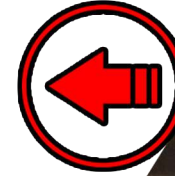
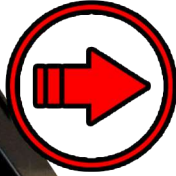

***! Ensure 2 brush cable entries match the rectangular vented holes at the bottom.***

***! Ensure the brush cable entry matches the rectangular vented hole in the front of the top cover.***

***STEP# 4***



# ***STEP# 5***

*Only for 32U/42U  
Server Racks*

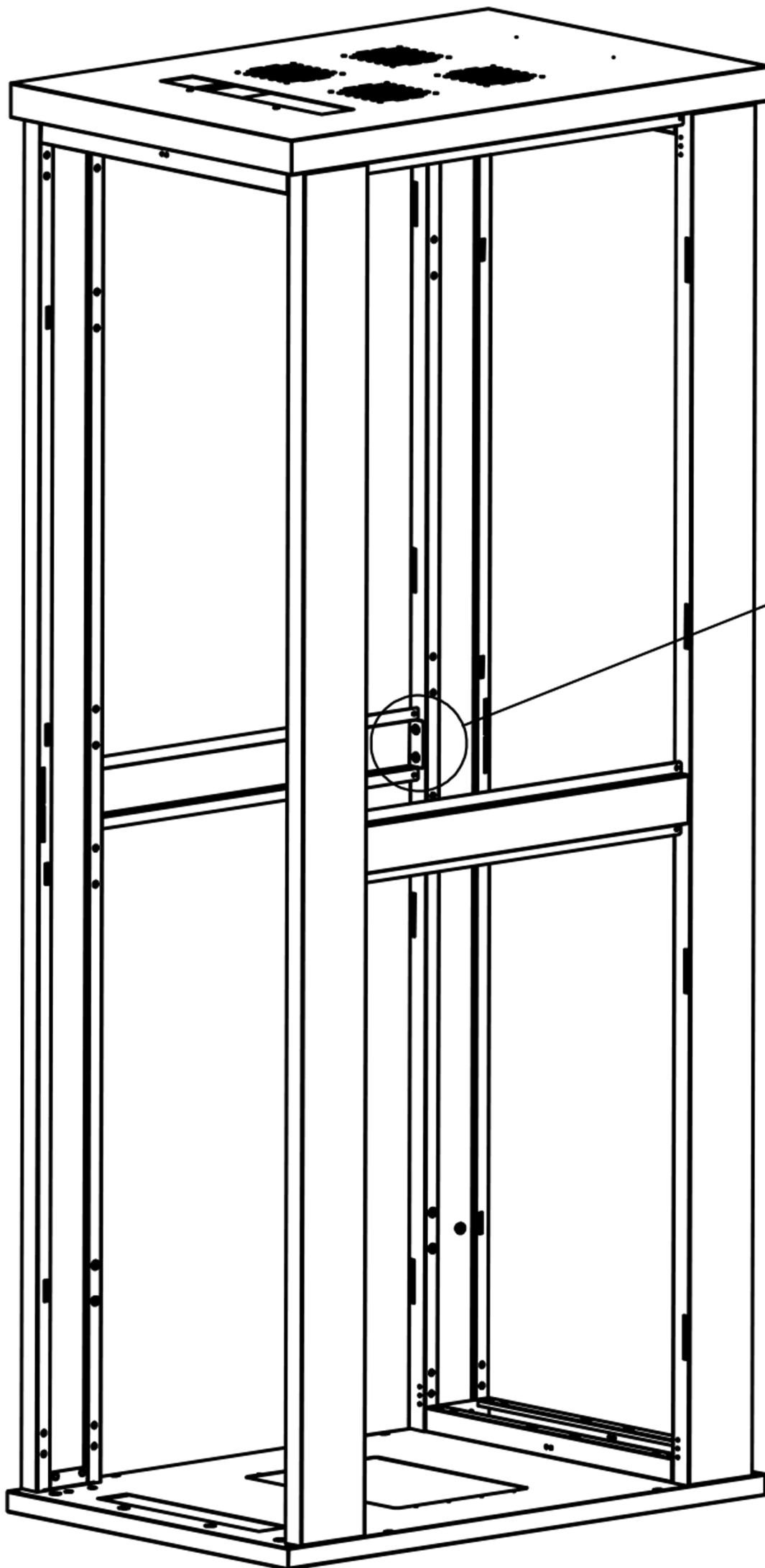

*Using the bolts # 1,  
nuts # 2, install the  
intermediate horizontal  
side panels supporting  
beams on each side.*



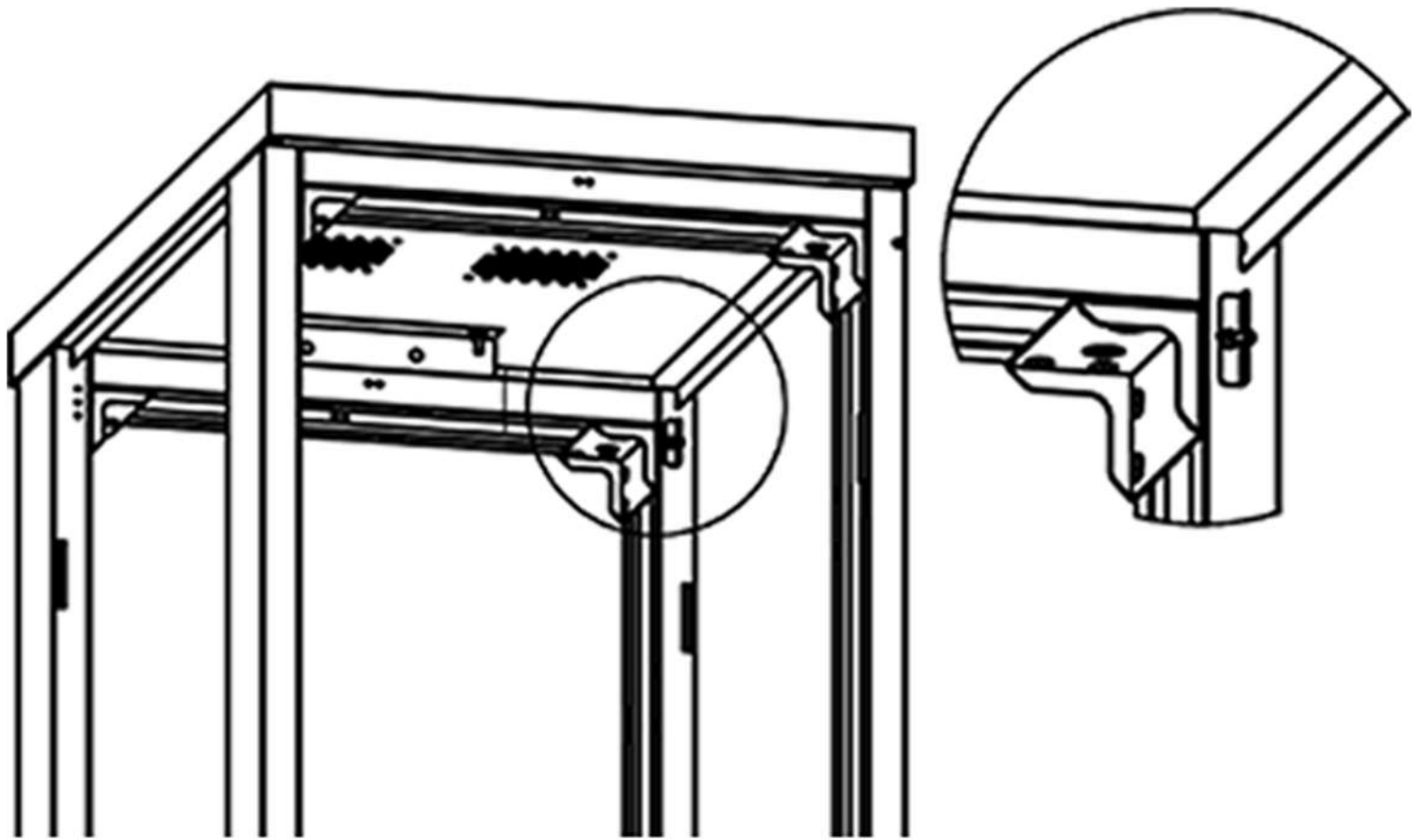

## ***STEP #6***

***1. Using the self-taping screws #6, screw the aluminum side panel stoppers and insert the rubber dowels.***

***18U/22U/27U – 4 pcs, 32U/42U – 8 pcs***

# STEP #7

*Installation of the horizontal  
mounting rails*

*18U/22U/27U – 4 horizontal beams,  
32U/42U – 6 horizontal beams*

*Insert the horizontal beam  
brackets into rectangular  
cuts in the both frames  
on same height.*

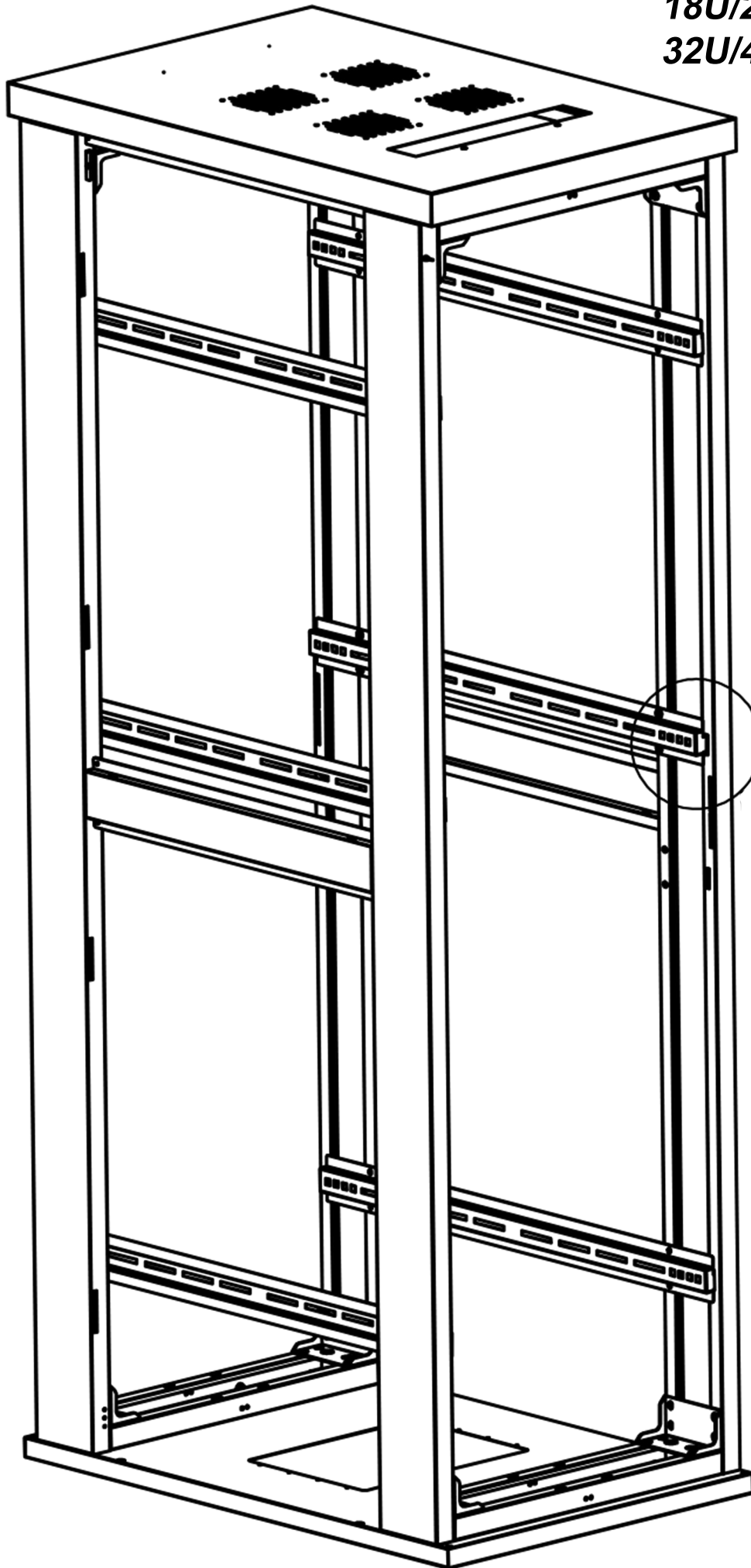

*Secure the horizontal  
beams with M5 bolts  
(plastic bag #8).*



# **STEP #8**

## ***Installation of the U-Mark vertical mounting rails***

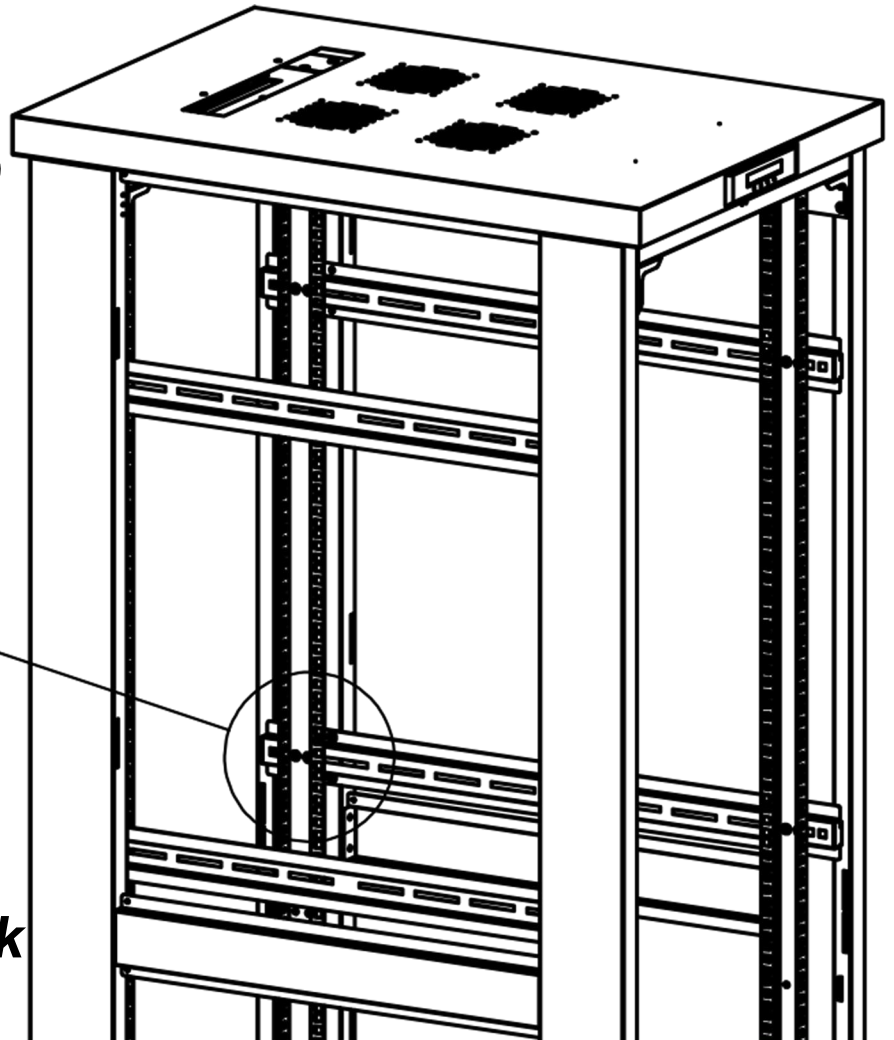
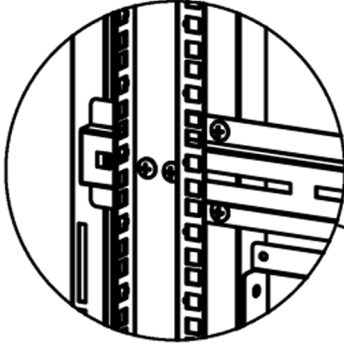

***Using bolts #1 and nuts #2, set the vertical U-mark mounting rails.***

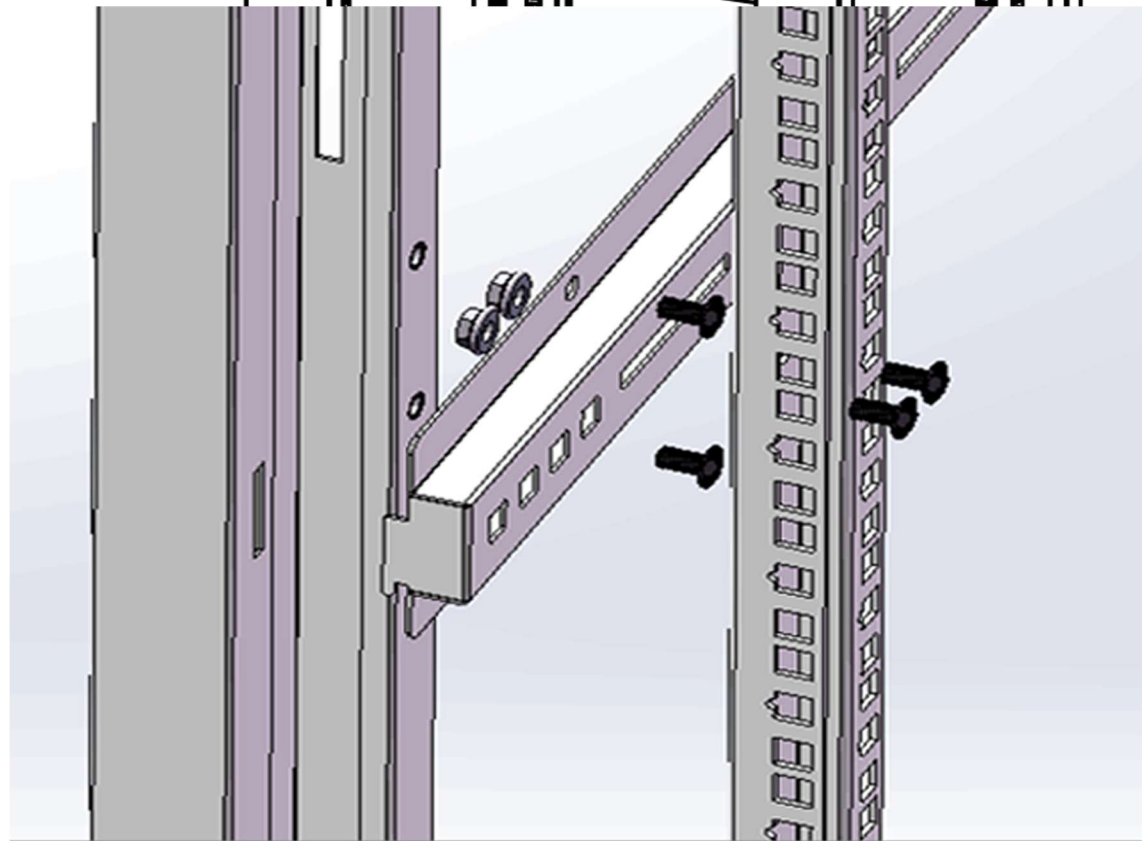

***!!! The distance between the vertical rails is to be determined in advance based on the mounting equipment (or, the depth of the supplied fixed shelf)***



## ***STEP #9***

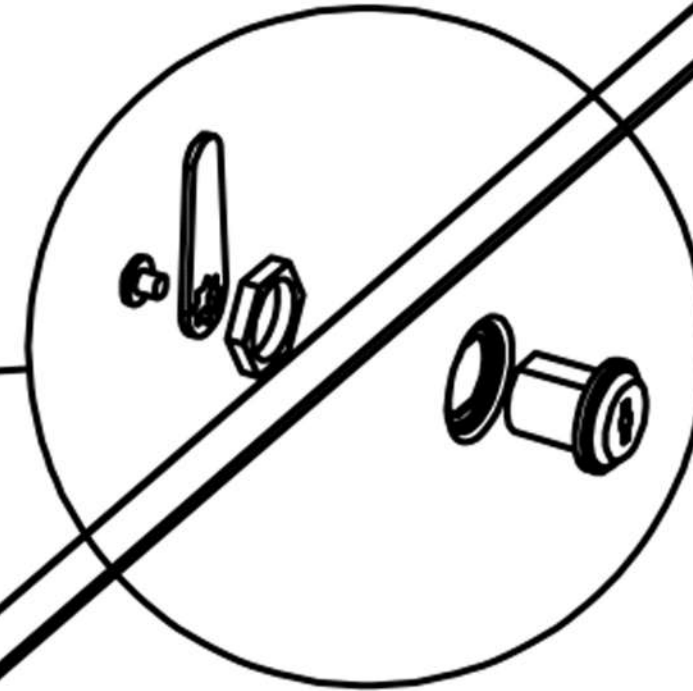
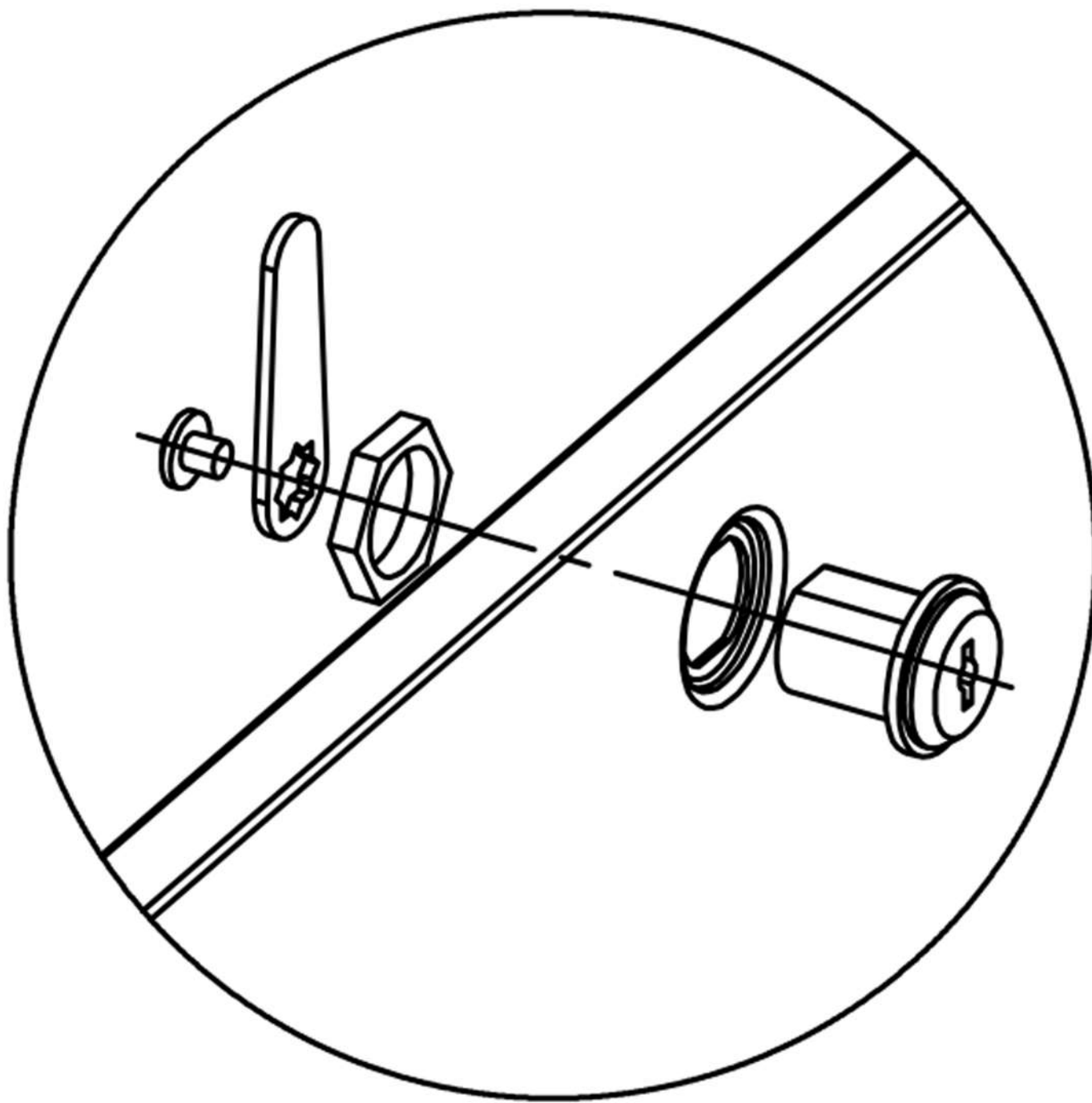

***Install the side panel locks  
and plastic latches***

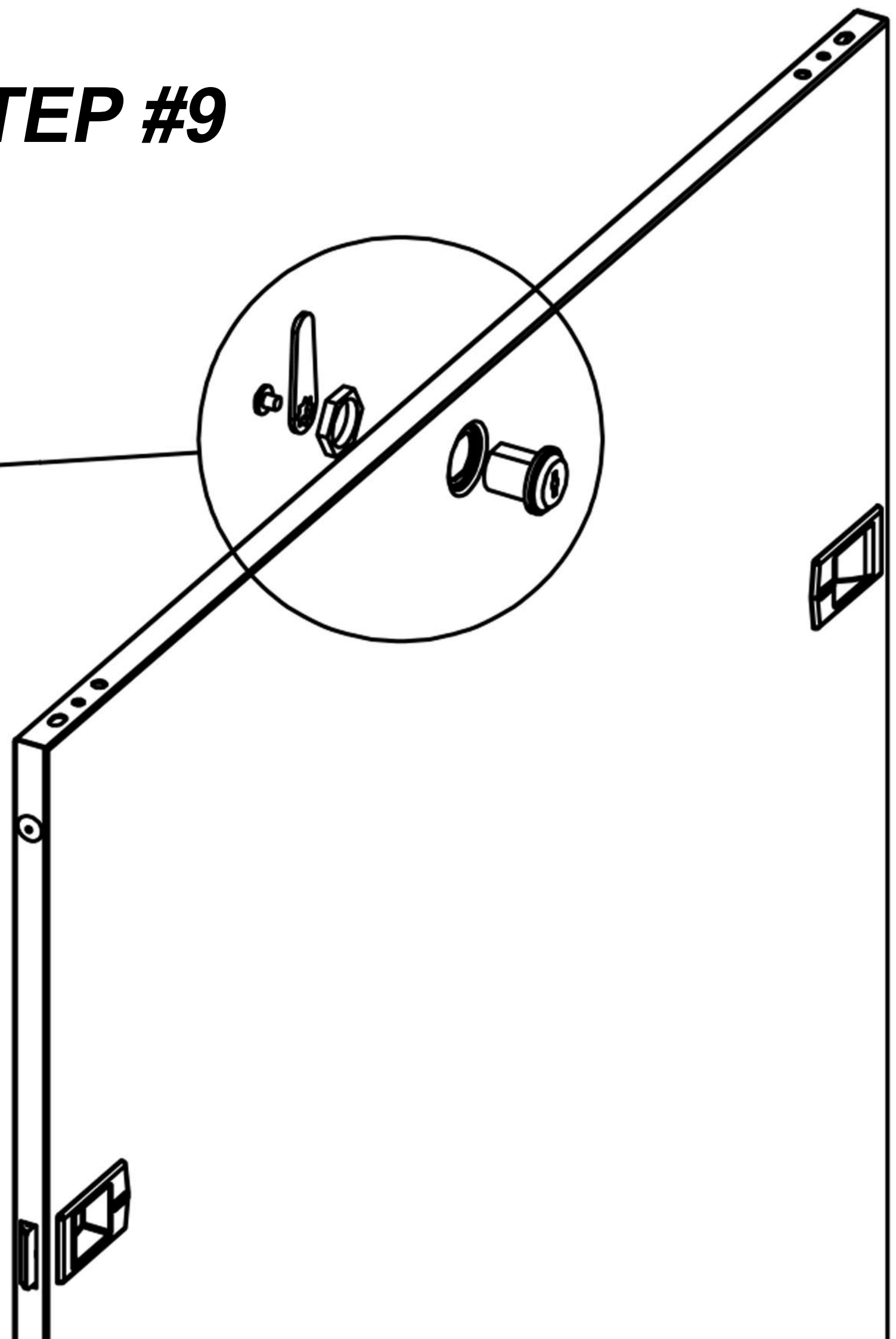

# ***STEP #10***

**Insert the plastic bushings onto the metal pins  
on top/bottom of the front/rear doors**

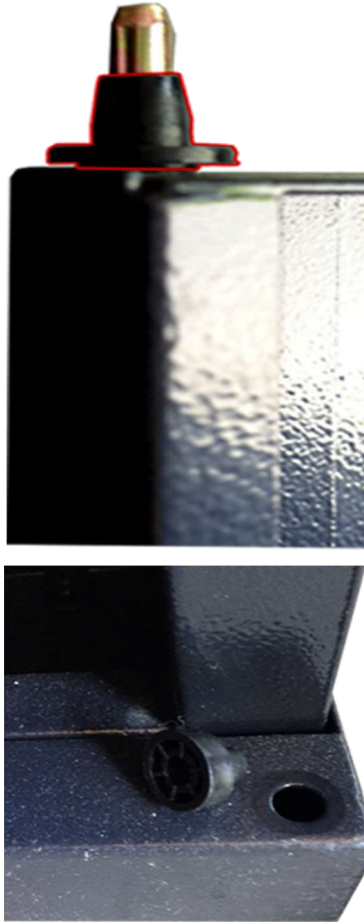
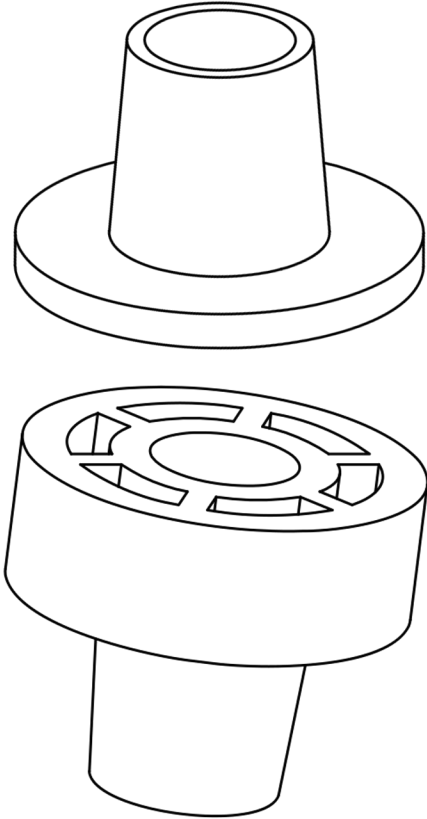

**Install the doors by pulling down  
and releasing the metal spring hinge**

Install the front door handle.  
Install the rear door lock

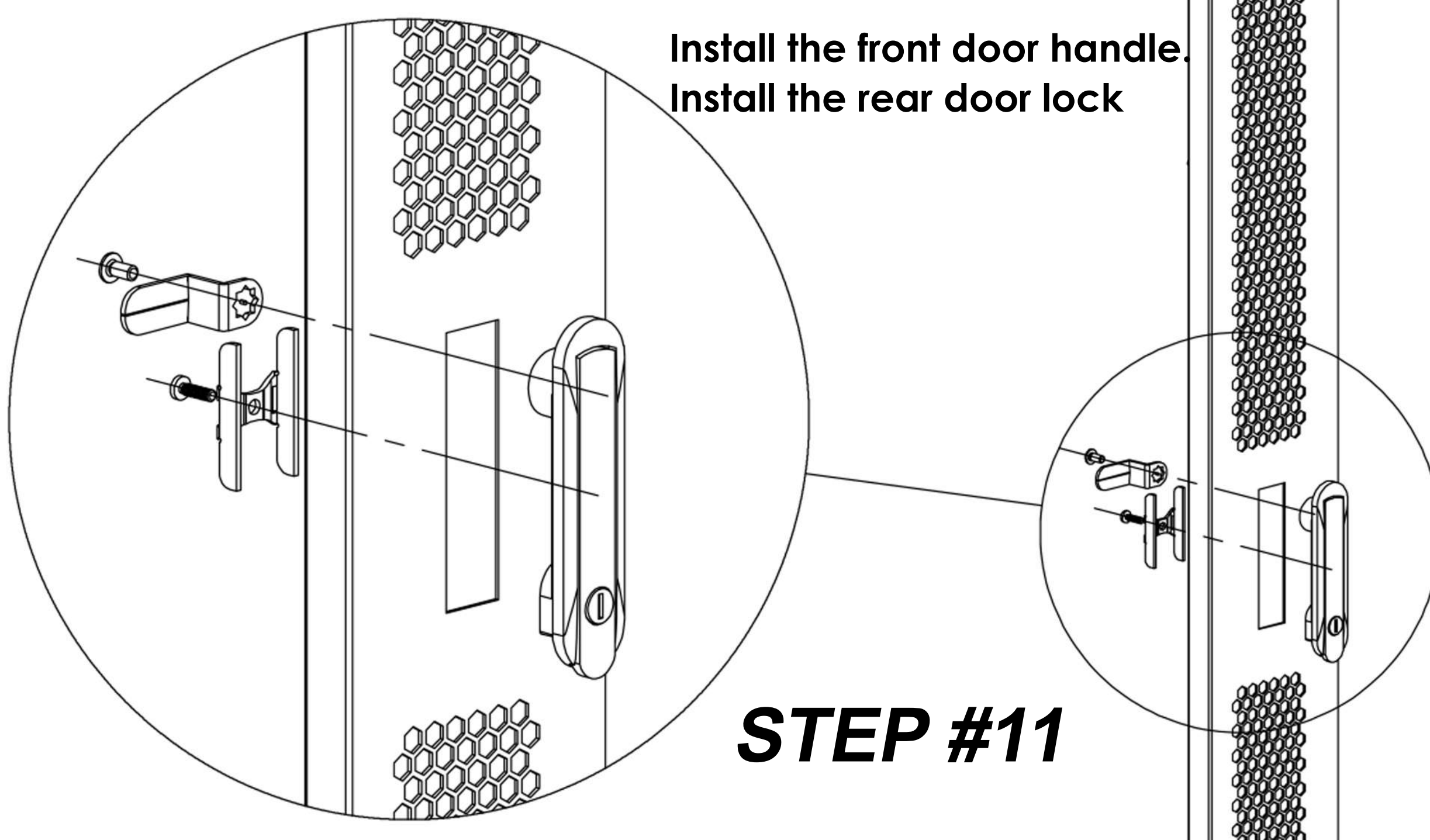

***STEP #11***



# STEP #12

**Screw 4 blank panels to the bottom main cable entry using the self tapping screws# 5.  
Or, configure the cable entry on your needs.**

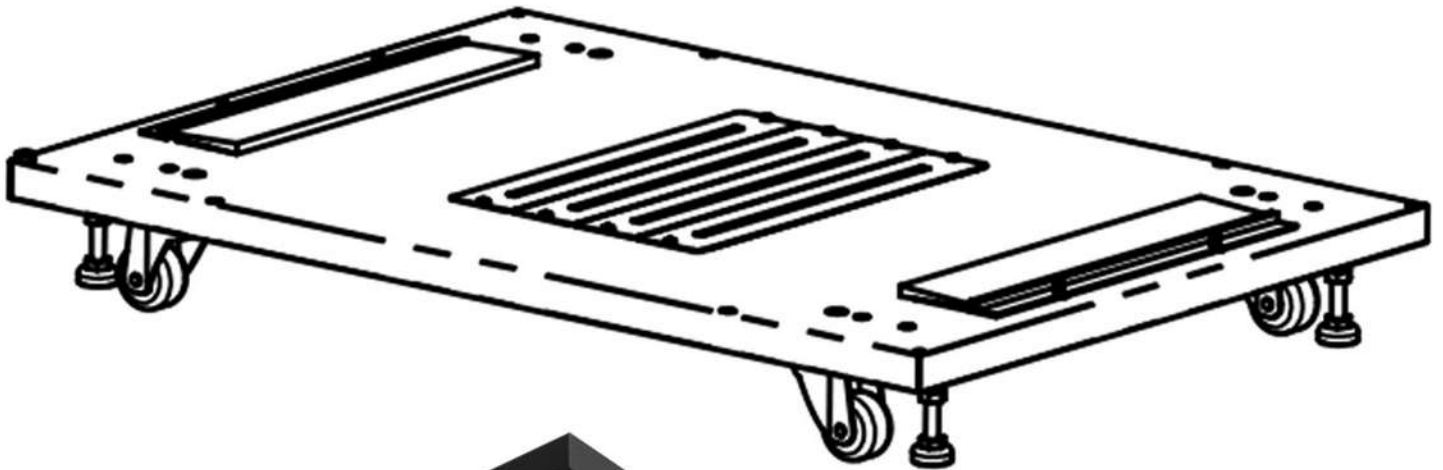

**Tighten all bolt connections now.**

**The rack is ready now.**